

SYDNEY 22-23 MAY 2024

SYDNEY SHOWGROUND

Sydney Olympic Park, Halls 5 & 6



www.atsaindependentlivingexpo.com.au

Exhibitor Listing

- | | | | |
|-----|-----------------------------------|-----|--|
| 2 | Everybody ebikes | 218 | Apex Mobility |
| 6 | Remarkable | 218 | Astris PME |
| 6 | Cerebral Palsy Alliance | 204 | GTK |
| 12 | ATSA | 206 | Memory Machine |
| 16 | Avante | 208 | Active Medical |
| 18 | HiLine Home Modifications | 210 | Neuromersiv |
| 20 | RehabTechnology | 212 | Canterbury Concepts |
| 24 | Showerbuddy | 214 | Link Assistive |
| 28 | Trivida | 216 | Wheelie Essential |
| 30 | Acorn Stairlifts | 218 | Pure Wheelchairs |
| 32 | Trionic Australia | 220 | Neeki Wondersheet |
| 33 | NDIS | 222 | Mobility Engineering |
| 36 | Sleep Electric | 224 | Country Care Group |
| 40 | Allied X | 226 | Brazier Mobility |
| 50 | Medifab | 230 | Active Mobility |
| 56 | For-De Group | 236 | Mogo Wheelchairs |
| 60 | ResMed | 236 | Melrose Wheelchairs |
| 62 | Performance Health | 236 | ROVE Wheelchairs |
| 66 | Wholesale Mobility | 240 | Specialised Wheelchair Company |
| 90 | Blue Badge Insurance | 246 | Dejay |
| 92 | Quantum RLV | 250 | Sunrise Medical |
| 94 | Opel Mobile | 252 | Theorem Power Lift Recliners |
| 104 | Muve Tech | 256 | Deutscher Healthcare |
| 110 | Merits Australia | 258 | Care Quip |
| 114 | NeuroMuscular Orthotics | 260 | Alpha Lifecare |
| 118 | Forté Healthcare | 266 | Invacare |
| 120 | Equipsy | 272 | Allegro Concepts |
| 122 | Occupational Therapy Australia | 276 | Ottobock |
| 126 | Disability Safe Seating Solutions | 278 | Handi Rehab |
| 128 | Christina Stephens | 282 | Live Life Alarms |
| 130 | Rolapal | 284 | Participant Assistive Products |
| 132 | Gilani Engineering | 290 | Active Rehab |
| 134 | TiMotion | 294 | Tyrex Solutions |
| 136 | Finch Healthcare | 296 | Topcat Healthcare |
| 140 | Aidacare | 298 | Seating Matters |
| 144 | Whill | 300 | Home Modifications Solutions (HMS) |
| 145 | Empower Healthcare | 301 | Uniting Local Area Coordination - NDIS |
| 146 | Livewell by Caroma | 302 | HelloMosma |
| 148 | Auckland Health Services | 303 | Hercules Complete Lifting Solutions |
| 150 | Novis Healthcare | 306 | Niagara Medical Therapy |
| 152 | WILA Innovations | 308 | KiddiKutter |
| 154 | Oscar Furniture | 310 | MovingStar International |
| 160 | Hospequip | 314 | Superyou Tech |
| 164 | Pride Mobility | 315 | Freedom Solutions |
| 172 | Magic Mobility | 316 | CareAlert |
| 176 | Linds Rehabilitation Equipment | | |
| 180 | Paragon Mobility | | |

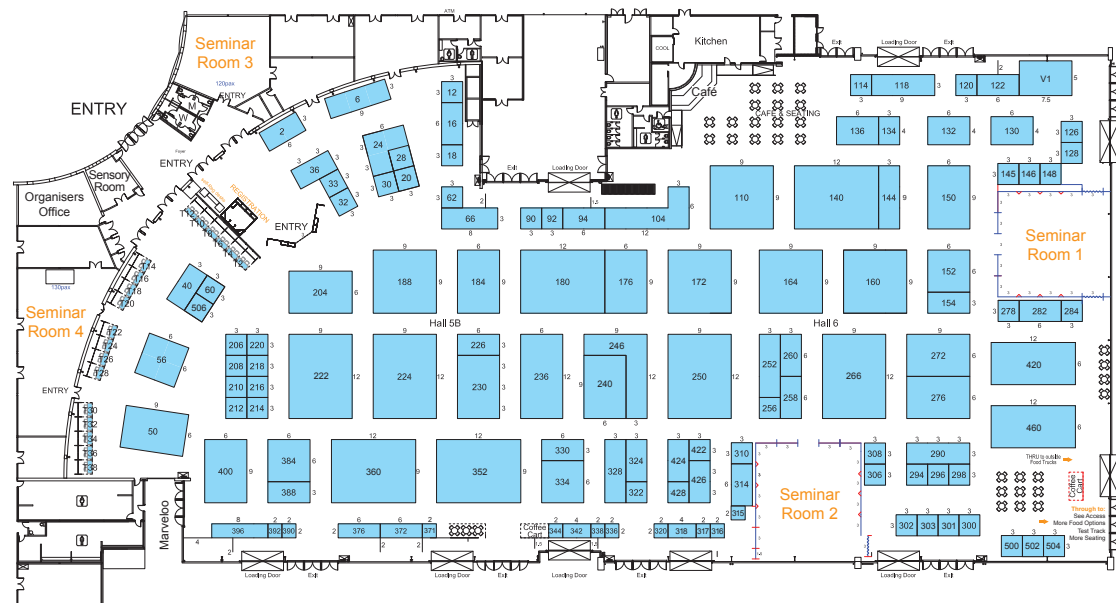

- | | | | | | |
|-----|----------------------------------|-----|--------------------------------------|-----|--------------------------------------|
| 317 | MARFAB Technical Solutions | 390 | HMR Healthcare | T10 | Bakslap |
| 318 | DAL Brands | 392 | My Buddy Gard Personal GPS Trackers | T12 | Jadco Time |
| 320 | Guardian Safety Pendants | 396 | Avant Innovations | T14 | Verve OT |
| 322 | Lodgesons | 400 | Automobility | T16 | MACA |
| 324 | Healthcare Innovations Australia | 420 | Freedom Motors | T18 | Northern Beaches Rehabilitation |
| 328 | Total Ability | 422 | Convatec | T20 | Scanning Pens |
| 330 | Kevrek | 424 | Mounties Care | T22 | Unique Starshine |
| 334 | Cobalt Health | 426 | Sleeptime | T24 | Symplbrush |
| 336 | Ambassador Motion Furniture | 428 | Allianz Global Assistance | T26 | Amplify-Accessible Travel Specialist |
| 338 | Mintti Health Australia | 460 | Problem Management Engineering | T28 | HandyScoot |
| 342 | Aesthetics Healthcare | 500 | TabTimer | T30 | Ramp Ability |
| 344 | Aqua Access | 502 | Communicate AT | T32 | AFL |
| 352 | Permobil | 504 | Stealth Products | T34 | MySkill |
| 360 | K Care Healthcare Solutions | 506 | Regency Care | T36 | CareWindow |
| 371 | Homeable - Smart Home | | | T38 | Cloud Burst |
| 372 | Sleeptite | T2 | KISA | V1 | Mobi Nomad |
| 376 | HomeLife Technology | T4 | ARATA | V2 | Sea Access |
| 384 | Independent Living Specialists | T6 | BigPurplePhone | | |
| 388 | IMG Comfort | T8 | NSW Ageing and Disability Commission | | |